

# Licensing and Regulatory Sub- Committee



**Forest Heath**  
District Council

<b>Title:</b>	<b>Agenda</b>
<b>Date:</b>	<b>Monday 18 September 2017</b>
<b>Time:</b>	<b><u>9.30am</u> – Briefing for the Members of the Sub-Committee to be held in the Members' Room</b> <b><u>10.00am</u> – Hearing commences</b>
<b>Venue:</b>	<b>Council Chamber</b> <b>District Offices</b> College Heath Road Mildenhall
<b>Full Members (3):</b>	Brian Harvey Carol Lynch Nigel Roman
<b>The membership of this Sub-Committee is drawn from Members of the full Licensing Committee and needs not to be politically balanced.</b>	
<b>Substitutes:</b>	Named substitutes are not appointed
<b>Interests – Declaration and Restriction on Participation:</b>	Members are reminded of their responsibility to declare any disclosable pecuniary interest not entered in the Authority's register or local non pecuniary interest which they have in any item of business on the agenda (subject to the exception for sensitive information) and to leave the meeting prior to discussion and voting on an item in which they have a disclosable pecuniary interest.
<b>Quorum:</b>	Two Members
<b>Committee administrator:</b>	<b>Helen Hardinge</b> Democratic Services Officer <b>Tel:</b> 01638 719363 <b>Email:</b> <a href="mailto:helen.hardinge@westsuffolk.gov.uk">helen.hardinge@westsuffolk.gov.uk</a>

## **LICENSING ACT 2003 – HEARING PROCEDURE**

### **Pre-Hearing Matters**

1. Declaration of Interests
2. Chairman will introduce members of the Hearing Panel
3. Chairman will ask those present to introduce themselves in the following order:
  - Applicant and any person representing or assisting them (Confirmation also should be given that copies of the relevant representations to be considered at the Hearing have been received);
  - The Officer of the Licensing Authority, the Committee Administrator and the Legal Advisor to the Hearing Panel;
  - Responsible authorities that have made a relevant representation;
  - Interested parties who have made a relevant representation (Interested parties should confirm whether a spokesperson has been nominated and, if so identify them);
  - In the event of a review hearing, the respondent.
4. The Chairman will ask all parties to the Hearing whether they wish to withdraw their application or representation.
5. The Chairman will ask the Officer of the Licensing Authority to report:
  - Any requests from a party to the Hearing for permission for a witness to appear in support of their representation. Any such requests will be determined by the Hearing Panel.
  - Any documentary or other information that a party to the Hearing wishes to present. If there is any such material, the Chairman will ask all the other parties to the Hearing whether they consent to it being presented. If they agree, the material will be distributed. If not, the said material may not be distributed unless there are exceptional circumstances which in the Chairman's opinion render it necessary and appropriate for the said material to be presented to the Hearing Panel. In this regard the Chairman's decision will be final.
6. The Chairman will invite the applicant or his representative to estimate the time required to present their case and ask questions of other parties to the Hearing. He will then ask the other parties to the Hearing whether they will require a longer period to present their representation and question the applicant. The Hearing Panel will determine the maximum period of time allowed for each party to put their case. This decision will be final.

## **THE HEARING**

Immediately the pre-Hearing matters have been dealt with the Hearing will commence.

1. The Chairman will ask the Officer of the Licensing Authority to summarise the matter under consideration.
2. The members of the Hearing Panel, the applicant, and those making representations may ask questions of the Officer of the Licensing Authority.
3. Starting with the applicant and, in the event of a review, concluding with the respondent, each party will exercise their rights within the identified maximum time, as follows:
  - Each party to present their case, including responding to any points of which the Licensing Authority has previously given notice, and call any approved witness or witnesses in support of their case.
  - If given permission by the Chairman, and only through the Chairman of the Hearing, each member of Sub Committee, office of the Licensing Authority or any party may raise questions of any other party or witness/witnesses.
4. Starting with the applicant and, in the event of a review hearing, concluding with the respondent, each party will be asked to sum up their case.
5. All those present, other than the members of the Hearing Panel, their Legal Advisor and the Committee Administrator, will be asked to leave the meeting to allow Members to determine the application.
6. All parties will be recalled. The Legal Advisor to the Hearing Panel will advise those present of any advice that has been provided during the determination. The Chairman will then:
  - either announce the decision, together with the reasons for it if it is a Hearing in relation to an application for which the Licensing Authority may make its determination at the conclusion of the Hearing; OR
  - advise all the parties that the Licensing Authority will make its determination within 5 working days, in which case notification of the determination will be sent out in writing (including the rights of appeal) to all relevant parties not later than 5 working days after the Hearing date.

7. In the event of the Licensing Authority making its determination at the conclusion of the Hearing the Chairman will outline the rights of appeal. The decision and rights of appeal will also be confirmed in writing by the Officer of the Licensing Authority forthwith.
  8. Nothing within paragraph 6 above will preclude a Licensing Authority from making its determination at the conclusion of any Hearing, should the Hearing Panel so decide. It is entirely within the discretion of the Members of the said Panel whose decision in this regard will be final.
-

# **Agenda**

## **Procedural Matters**

### **Part 1 – Public**

- 1. Apologies for Absence**
- 2. Substitutes**
- 3. Election of Chairman**
- 4. Application for the Grant of a Premises Licence - Black Bess, 7 Rous Road, Newmarket** **1 - 66**  
Report No: **LSC/FH/17/002**

This page is intentionally left blank

# Licensing and Regulatory Sub-Committee



**Forest Heath**  
District Council

<b>Title of Report:</b>	<b>Application for the Grant of a Premises Licence – Black Bess, 7 Rous Road, Newmarket</b>	
<b>Report No:</b>	<b>LIC/FH/17/002</b>	
<b>Report to and date/s:</b>	Licensing and Regulatory Sub-Committee	18 September 2017
<b>Portfolio holder:</b>	Councillor Lance Stanbury Portfolio Holder for Planning and Growth <b>Tel:</b> 07970 947704 <b>Email:</b> <a href="mailto:lance.stanbury@forest-heath.gov.uk">lance.stanbury@forest-heath.gov.uk</a>	
<b>Lead officer:</b>	Sheila Gowans Licensing Officer <b>Tel:</b> 01638 719369 <b>Email:</b> <a href="mailto:sheila.gowans@westsuffolk.gov.uk">sheila.gowans@westsuffolk.gov.uk</a>	
<b>Purpose of report:</b>	To determine an application for the grant of a premises licence under the Licensing Act 2003.	
<b>Recommendation:</b>	<p><b>It is recommended that, having regard to the four licensing objectives; Statement of Licensing Policy; the representations; any further relevant information presented on the day of the Hearing; Members take any of the steps set out below provided they are proportionate and appropriate for the promotion of the four licensing objectives:</b></p> <ul style="list-style-type: none"> <li><b>(1) Approve the application; or</b></li> <li><b>(2) Modify the conditions of the licence and approve the application; or</b></li> <li><b>(3) Reject the application.</b></li> </ul>	

<b>Key Decision:</b>	<i>Is this a Key Decision and, if so, under which definition?</i> No, it is not a Key Decision - <input checked="" type="checkbox"/>		
<b>Consultation:</b>	See number 4 below		
<b>Alternative option(s):</b>	N/A – the Council is duty bound to determine the application		
<b>Implications:</b>			
Are there any <b>financial</b> implications? If yes, please give details		Yes <input type="checkbox"/> No <input checked="" type="checkbox"/>	
Are there any <b>staffing</b> implications? If yes, please give details		Yes <input type="checkbox"/> No <input checked="" type="checkbox"/>	
Are there any <b>ICT</b> implications? If yes, please give details		Yes <input type="checkbox"/> No <input checked="" type="checkbox"/>	
Are there any <b>legal and/or policy</b> implications? If yes, please give details		Yes <input checked="" type="checkbox"/> No <input type="checkbox"/> See number 5 below	
Are there any <b>equality</b> implications? If yes, please give details		Yes <input type="checkbox"/> No <input checked="" type="checkbox"/>	
<b>Risk/opportunity assessment:</b>		<i>(potential hazards or opportunities affecting corporate, service or project objectives)</i>	
<b>Risk area</b>	<b>Inherent level of risk</b> (before controls)	<b>Controls</b>	<b>Residual risk</b> (after controls)
Any decision reached which is not in accordance with the Act and any regulations made under the Act may be considered ultra vires and could be subject to an application for Judicial Review	High	The Sub-Committee, should have regard to it's statement of licensing policy and any other guidance issued under section 182 of the Licensing Act 2003, but may depart from these where reasons are given.	Low
<b>Ward(s) affected:</b>		All Saints	
<b>Background papers:</b>		Licensing Act 2003 S.182 Guidance <a href="https://www.gov.uk/government/publications/explanatory-memorandum-revised-guidance-issued-under-s-182-of-licensing-act-2003">https://www.gov.uk/government/publications/explanatory-memorandum-revised-guidance-issued-under-s-182-of-licensing-act-2003</a>  Forest Heath Statement of Licensing Policy <a href="http://www.forestheath.gov.uk/info/200063/licences_and_street_trading/22/statement_of_licensing_policy">http://www.forestheath.gov.uk/info/200063/licences_and_street_trading/22/statement_of_licensing_policy</a>	



<b>Documents attached:</b>	<i>(Please list any appendices.)</i> Appendix 1 – Application Appendix 2 – Map of the immediate area Appendix 3 - Representation Kinnett Appendix 4 – Representation Anderson Appendix 5 – Representation Ryan Appendix 6 – Representation Haynes Appendix 7 – Representation Coombes Appendix 8 – Representation Cowell Appendix 9 – Representation Jackson/Cowell Appendix 10 – Representation Cook Appendix 11 – Representation Long Appendix 12 – Representation Lanham Appendix 13 – Representation Jeffrey Appendix 14 – Representation Van Der Werff Appendix 15 – Representation Richer Appendix 16 – Representation Lewis Appendix 17 – Representation Martin Appendix 18 – Representation Bennett Appendix 18 – Representation Considine Appendix 20 – Representation Hornsby Appendix 21 – Representation Batten Appendix 22 – Petition
----------------------------	--

## 1. Key issues

- 1.1 An application has been received for the grant of a premises licence for Black Bess, 7 Rous Road, Newmarket. A copy of the application is attached which includes a plan of the premises as **Appendix 1**.
- 1.2 The application is for a coffee and craft beer micro pub/café specialising in the sale of beers brewed locally by small independent brewers and specialist coffee and tea from sustainable sources.

The licensable activities applied for are recorded music and the sale of alcohol for consumption on and off the premises.

The opening hours are Monday to Thursday 08.30 to 23.15, Friday and Saturday 08.30 to 23.30 and Sunday 08.30 to 23.00.

- 1.3 A map showing the immediate area is attached as **Appendix 2**.
- 1.4 The four Licensing Objectives of the Licensing Act 2003 are set out below. Any representations for consideration must relate to one or more of these objectives.
  - Prevention of Crime and Disorder
  - Public Safety
  - Prevention of Nuisance
  - Protection of Children from Harm

## **2. Relevant Representations**

- 2.1 The application has to be advertised, both at the premises and in a local newspaper. Details are also available on the Council website. This application was advertised in the Newmarket Journal on 27 July 2017.
- 2.2 **Responsible Authority** There are no representations from any responsible authority.
- 2.3 **Other Persons** Any representation made by these persons must be 'relevant' in that the representation relates to one or more of the licensing objectives. There have been a number of representations from other persons, which are attached as **Appendix 3 to 21**.  
A petition has also been submitted and it is for the Members to decide what weight to give to this. Many of the signatories have submitted individual representations. Some signatories have not given their full address and the reasons for signing do not always relate to the possible undermining of the licensing objectives. This is attached as **Appendix 22**.

## **3. Matters for consideration**

- 3.1 Section 17 of the Crime and Disorder Act 1998 imposes a duty on each local authority to exercise its various functions with due regard to the likely effect of the exercise of those functions on, and the need to do all that it reasonably can to prevent crime and disorder in its area.
- 3.2 The location of the premises is outside of the Cumulative Impact area of Newmarket.
- 3.3 If the Licensing Authority decides that this application should be refused, it will need to show that to grant the licence would:
1. undermine the promotion of the licensing objectives; and
  2. that appropriate conditions would be ineffective in preventing the problems involved.

If the Licensing Authority cannot show the above, the application should be granted.

- 3.4 In making their decision, Members are advised to consider the Licensing Act 2003, the Guidance on the Act and the Council's Statement of Licensing Policy.

## **4. Consultation**

- 4.1 The applicant is required to place a notice on the premises; and advertise the application in a locally circulating newspaper/periodical. The Licensing Authority advertises the application on the Council website.

## **5. Legal and policy implications**

- 5.1 The Sub-Committee may take any of the steps set out below, provided they are proportionate and appropriate for the promotion of the Licensing Objectives:
- a) Approve the application; or

- b) modify the conditions of the licence and approve the application; or
- b) reject the whole or part of the application.

A condition is modified where it is altered or omitted or any new condition is added.

- 5.2 Section 6 of the Licensing Statement of Policy, paragraph 6.1, as set out below, is relevant and is brought to the attention of the Licensing Act Sub-Committee: "The Licensing Authority, through the exercise of its licensing functions once its discretion is engaged, shall not seek to restrict the trading hours of any particular premises unless it is considered necessary and proportionate to promote one or more of the licensing objectives. Each application will be considered individually on its own merits;"
- 5.3 Each application should be considered on its own merits, having regard to the Council's Statement of Licensing Policy and the guidance issued under section 182 of the Licensing Act 2003. Only the relevant parts of the representations should be taken into account, for example many of the representations refer to parking as a problem, Members should be mindful that this is outside of the licensing remit.
- 5.8 The licence application is made in accordance with the Licensing Act 2003 and the Licensing Statement of Policy. The decision may be appealed, by the applicant or any other party to the hearing, within 21 days of written notification of the determination made by the sub-committee.
- 5.9 When representations have been made the Council must hold a Hearing within 20 working days of the close of the consultation period. The Licensing Act 2003 (Hearings) Regulations 2005 allows the Licensing Authority the power to extend the time limit for a specific period, when it considers this to be necessary and in the public interest.

This page is intentionally left blank

£190 paid  
Inc.

**Application for a premises licence to be granted  
under the Licensing Act 2003**

**PLEASE READ THE FOLLOWING INSTRUCTIONS FIRST**

Before completing this form please read the guidance notes at the end of the form. If you are completing this form by hand please write legibly in block capitals. In all cases ensure that your answers are inside the boxes and written in black ink. Use additional sheets if necessary.

You may wish to keep a copy of the completed form for your records.

I/We Marcus Turpin

(Insert name(s) of applicant)

**apply for a premises licence under section 17 of the Licensing Act 2003 for the premises described in Part 1 below (the premises) and I/we are making this application to you as the relevant licensing authority in accordance with section 12 of the Licensing Act 2003**

**Part 1 – Premises details**

Postal address of premises or, if none, ordnance survey map reference or description <b>Black Bess 7 Rous Road Newmarket Suffolk</b>			
<b>Post town</b>	Newmarket	<b>Postcode</b>	<b>CB8 8DH</b>

Telephone number at premises (if any)	
Non-domestic rateable value of premises	£ <b>9633</b>

**Part 2 - Applicant details**

Please state whether you are applying for a premises licence as      Please tick as appropriate

- |    |  |                                     |                             |
|----|--|-------------------------------------|-----------------------------|
| a) | an individual or individuals *                       | <input checked="" type="checkbox"/> | please complete section (A) |
| b) | a person other than an individual *                  |                                     |                             |
|    | i as a limited company/limited liability partnership | <input type="checkbox"/>            | please complete section (B) |
|    | ii as a partnership (other than limited liability)   | <input type="checkbox"/>            | please complete section (B) |
|    | iii as an unincorporated association or              | <input type="checkbox"/>            | please complete section (B) |
|    | iv other (for example a statutory corporation)       | <input type="checkbox"/>            | please complete section (B) |
| c) | a recognised club                                    | <input type="checkbox"/>            | please complete section (B) |
| d) | a charity  | <input type="checkbox"/>            | please complete section (B) |

- e) the proprietor of an educational establishment ☐ please complete section (B)
- f) a health service body ☐ please complete section (B)
- g) a person who is registered under Part 2 of the Care Standards Act 2000 (c14) in respect of an independent hospital in Wales ☐ please complete section (B)
- ga) a person who is registered under Chapter 2 of Part 1 of the Health and Social Care Act 2008 (within the meaning of that Part) in an independent hospital in England ☐ please complete section (B)
- h) the chief officer of police of a police force in England and Wales ☐ please complete section (B)

\* If you are applying as a person described in (a) or (b) please confirm (by ticking yes to one box below):

I am carrying on or proposing to carry on a business which involves the use of the premises for licensable activities; or x

I am making the application pursuant to a

statutory function or ☐

a function discharged by virtue of Her Majesty's prerogative ☐

**(A) INDIVIDUAL APPLICANTS** (fill in as applicable)

Mr <input checked="" type="checkbox"/>	Mrs <input type="checkbox"/>	Miss <input type="checkbox"/>	Ms <input type="checkbox"/>	Other Title (for example, Rev)	
<b>Surname</b> Turpin			<b>First names</b> Marcus		
<b>Date of birth</b> over		I am 18 years old or <input checked="" type="checkbox"/> Please tick yes			
<b>Nationality</b> <b>British</b>					
Current residential address if different from premises address		Trumpinton			
Post town	Cambridge			Postcode	
<b>Daytime contact telephone number</b>					
<b>E-mail address (optional)</b>					

### Part 3 Operating Schedule

When do you want the premises licence to start?

DD		MM		YYYY			
0	1	<input type="checkbox"/>	0	9	<input type="checkbox"/>	2	0

If you wish the licence to be valid only for a limited period, when do you want it to end?

DD		MM		YYYY			
<input type="checkbox"/>	<input type="checkbox"/>	<input type="checkbox"/>	<input type="checkbox"/>	<input type="checkbox"/>	<input type="checkbox"/>	<input type="checkbox"/>	<input type="checkbox"/>

Please give a general description of the premises (please read guidance note 1)

The premises will be a coffee and craft beer micro pub/café, specialising in the sale of beers brewed locally by small independent brewers and specialist coffee and tea's from a sustainable source

If 5,000 or more people are expected to attend the premises at any one time, please state the number expected to attend.

What licensable activities do you intend to carry on from the premises?

(please see sections 1 and 14 and Schedules 1 and 2 to the Licensing Act 2003)

Provision of regulated entertainment (please read guidance note 2)

Please tick all that apply

- a) plays (if ticking yes, fill in box A) ☐
- b) films (if ticking yes, fill in box B) ☐
- c) indoor sporting events (if ticking yes, fill in box C) ☐
- d) boxing or wrestling entertainment (if ticking yes, fill in box D) ☐
- e) live music (if ticking yes, fill in box E) ☐
- f) recorded music (if ticking yes, fill in box F) ☒
- g) performances of dance (if ticking yes, fill in box G) ☐
- h) anything of a similar description to that falling within (e), (f) or (g) (if ticking yes, fill in box H) ☐

**Provision of late night refreshment** (if ticking yes, fill in box I)

☐

**Supply of alcohol** (if ticking yes, fill in box J)

x

**In all cases complete boxes K, L and M**



# F

<b>Recorded music</b> Standard days and timings (please read guidance note 7)			<b><u>Will the playing of recorded music take place indoors or outdoors or both – please tick</u></b> (please read guidance note 3)		Indoors	x
					Outdoors	<input type="checkbox"/>
					Both	<input type="checkbox"/>
Day	Start	Finish	<b><u>Please give further details here</u></b> (please read guidance note 4)			
Mon	11.00	23.00				
Tue	11.00	23.00	<b><u>State any seasonal variations for the playing of recorded music</u></b> (please read guidance note 5)			
Wed	11.00	23.00	<b><u>Non standard timings. Where you intend to use the premises for the playing of recorded music at different times to those listed in the column on the left, please list</u></b> (please read guidance note 6)			
Thur	11.00	23.00				
Fri	11.00	23.00				
Sat	11.00	23.00				
Sun	12.00	23.00				

# J

<b>Supply of alcohol</b> Standard days and timings (please read guidance note 7)			<b>Will the supply of alcohol be for consumption – please tick</b> (please read guidance note 8)	On the premises	<input type="checkbox"/>
				Off the premises	<input type="checkbox"/>
				Both	x
Day	Start	Finish	<b>State any seasonal variations for the supply of alcohol</b> (please read guidance note 5)		
Mon	11.00	23.15			
Tue	11.00	23.15			
Wed	11.00	23.15			
Thur	11.00	23.15			
Fri	11.00	23.30			
			<b>Non standard timings. Where you intend to use the premises for the supply of alcohol at different times to those listed in the column on the left, please list</b> (please read guidance note 6)		
Sat	11.00	23.30			
Sun	11.00	23.00			

**State the name and details of the individual whom you wish to specify on the licence as designated premises supervisor (Please see declaration about the entitlement to work in the checklist at the end of the form):**

Name Marcus Turpin	
Date of birth	21/11/1971
The Lord Byron Inn 22 Church Lane Trumpington Cambridge	
Postcode	CB2 9LA
Personal licence number (if known) CAM 001142	
Issuing licensing authority (if known) Cambridge City	

☐ ☐ ☐ ☐

K

**Please highlight any adult entertainment or services, activities, other entertainment or matters ancillary to the use of the premises that may give rise to concern in respect of children** (please read guidance note 9).

L

<b>Hours premises are open to the public</b> Standard days and timings (please read guidance note 7)			<b>State any seasonal variations</b> (please read guidance note 5)
Day	Start	Finish	
Mon	08.30	23.15	<b>Non standard timings. Where you intend the premises to be open to the public at different times from those listed in the column on the left, please list</b> (please read guidance note 6)
Tue	08.30	23.15	
Wed	08.30	23.15	
Thur	08.30	23.15	
Fri	08.30	23.30	
Sat	08.30	23.30	
Sun	08.30	23.00	

**M** Describe the steps you intend to take to promote the four licensing objectives:

**a) General – all four licensing objectives (b, c, d and e) (please read guidance note 10)**

**TO PROMOTE ALL FOUR LICENSING OBJECTIVES WE WILL KEEP:** Strong management controls and effective training of all staff so that they are aware of the premises licence and the requirements to meet the four licensing objectives with particular attention to: a/ no selling of alcohol to underage people b/ no drunk and disorderly behavior on the premises area c/ vigilance in preventing the use and sale of illegal drugs at the retail area d/ no violent and anti-social behavior e.

- Operating Schedule providing the hours of operation and licensable activities during those hours.- Designated premises supervisor confirmed it is obligated to be in day-to-day control of the premises, to provide good training for staff on the Licensing Act Clear "Challenge 25" information to prevent the supply of alcohol to under-age drinkers.- CCTV system installed with recording option available.

As a licensed premises we know that it is necessary to carry out our functions or operate their businesses with a purpose of promoting these objectives. We promise to support these objectives through their operating schedules and other measures (including staff training and qualifications, policies, and strategic partnerships with other agencies).

**b) The prevention of crime and disorder**

CCTV System installed to monitor entrances, exits, and other parts of the premises in order to address the prevention of crime objective. On a 2 week recording loop.

**c) Public safety**

Internal lighting fixed to promote the public safety objective. Training and implementation of underage ID checks will be made. Information compiled to comply with any public safety condition attached to the premises licence that requires the recording of such information. The log book shall be kept available for inspection when required by persons authorized by the Licensing Act 2003 or associated legislation.



**d) The prevention of public nuisance**

Prominent, clear and legible notices will be displayed at the exit requesting the public to respect the needs of nearby residents and to leave the premises and the area quietly. Customers will not be admitted to premises above opening hours. The movement of bins and rubbish outside the premises will be kept to a minimum after 11.00pm. This will help to reduce the levels of noise produced by the premises.

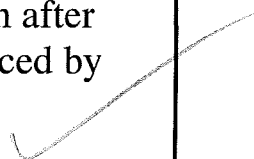

**e) The protection of children from harm**

"Challenge 25" sign which is a retailing strategy that encourages anyone who is over 18 but looks under 25 to carry acceptable ID (a card bearing the PASS hologram, a photographic driving license or a passport) if they wish to buy alcohol. Well trained staff about requirement for persons' identification, age establishment etc. No children will be permitted unaccompanied unless with an adult and not after 21.00 hours.

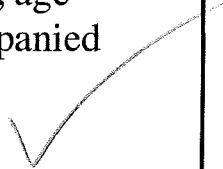

**Checklist:****Please tick to indicate agreement**

- I have made or enclosed payment of the fee. ☒
- I have enclosed the plan of the premises. ☒
- I have sent copies of this application and the plan to responsible authorities and others where applicable. ☒
- I have enclosed the consent form completed by the individual I wish to be designated premises supervisor, if applicable. ☒
- I understand that I must now advertise my application. ☒
- I understand that if I do not comply with the above requirements my application will be rejected. ☒
- ☐  
[Applicable to all individual applicants, including those in a partnership which is not a limited liability partnership, but not companies or limited liability partnerships] I have included documents demonstrating my entitlement to work in the United Kingdom (please read note 15). ☒

**IT IS AN OFFENCE, UNDER SECTION 158 OF THE LICENSING ACT 2003, TO MAKE A FALSE STATEMENT IN OR IN CONNECTION WITH THIS APPLICATION. THOSE WHO MAKE A FALSE STATEMENT MAY BE LIABLE ON SUMMARY CONVICTION TO A FINE OF ANY AMOUNT.**

**IT IS AN OFFENCE UNDER SECTION 24B OF THE IMMIGRATION ACT 1971 FOR A PERSON TO WORK WHEN THEY KNOW, OR HAVE REASONABLE CAUSE TO BELIEVE, THAT THEY ARE DISQUALIFIED FROM DOING SO BY REASON OF THEIR IMMIGRATION STATUS. THOSE WHO EMPLOY AN ADULT WITHOUT LEAVE OR WHO IS SUBJECT TO CONDITIONS AS TO EMPLOYMENT WILL BE LIABLE TO A CIVIL PENALTY UNDER SECTION 15 OF THE IMMIGRATION, ASYLUM AND NATIONALITY ACT 2006 AND PURSUANT TO SECTION 21 OF THE SAME ACT, WILL BE COMMITTING AN OFFENCE WHERE THEY DO SO IN THE KNOWLEDGE, OR WITH REASONABLE CAUSE TO BELIEVE, THAT THE EMPLOYEE IS DISQUALIFIED.**

**Part 4 – Signatures** (please read guidance note 11)

**Signature of applicant or applicant's solicitor or other duly authorised agent** (see guidance note 12). **If signing on behalf of the applicant, please state in what capacity.**

<b>Declaration</b>	<ul style="list-style-type: none"><li>• [Applicable to individual applicants only, including those in a partnership which is not a limited liability partnership] I understand I am not entitled to be issued with a licence if I do not have the entitlement to live and work in the UK (or if I am subject to a condition preventing me from doing work relating to the carrying on of a licensable activity) and that my licence will become invalid if I cease to be entitled to live and work in the UK (please read guidance note 15).</li><li>• The DPS named in this application form is entitled to work in the UK (and is not subject to conditions preventing him or her from doing work</li></ul>
--------------------	---

	relating to a licensable activity) and I have seen a copy of his or her proof of entitlement to work, if appropriate (please see note 15)
Signature	
Date	21-9-2017
Capacity	owner/applicant.

**For joint applications, signature of 2<sup>nd</sup> applicant or 2<sup>nd</sup> applicant's solicitor or other authorised agent (please read guidance note 13). If signing on behalf of the applicant, please state in what capacity.**

Signature	
Date	
Capacity	

Contact name (where not previously given) and postal address for correspondence associated with this application (please read guidance note 14)			
Post town		Postcode	
Telephone number (if any)			
If you would prefer us to correspond with you by e-mail, your e-mail address (optional)			

### Notes for Guidance

- Describe the premises, for example the type of premises, its general situation and layout and any other information which could be relevant to the licensing objectives. Where your application includes off-supplies of alcohol and you intend to provide a place for consumption of these off-supplies, you must include a description of where the place will be and its proximity to the premises.
- In terms of specific regulated entertainments please note that:
  - Plays: no licence is required for performances between 08:00 and 23.00 on any day, provided that the audience does not exceed 500.
  - Films: no licence is required for 'not-for-profit' film exhibition held in community premises between 08.00 and 23.00 on any day provided that the audience does not exceed 500 and the organiser (a) gets consent to the screening from a person who is responsible for the premises; and (b) ensures that each such screening abides by age classification ratings.
  - Indoor sporting events: no licence is required for performances between 08.00 and 23.00 on any day, provided that the audience does not exceed 1000.

**Lease Plan**

Floor Plan - 1:100

Site Plan - 1:250

Location Plan - 1:1250

To be printed to scale @ A4



**7 Rous Road**

**Newmarket**

**Suffolk**

**CB8 8DH**

**Location Plan**

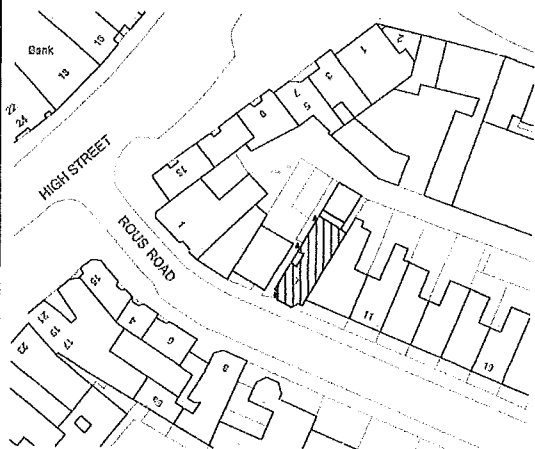

**Site Plan**

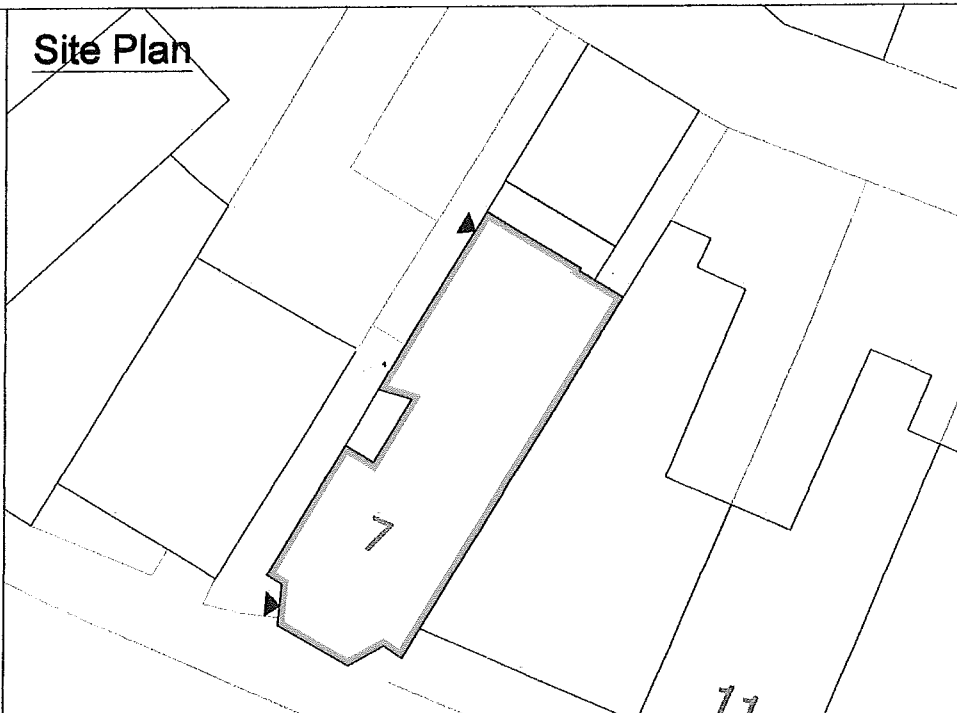

**Ground Floor**

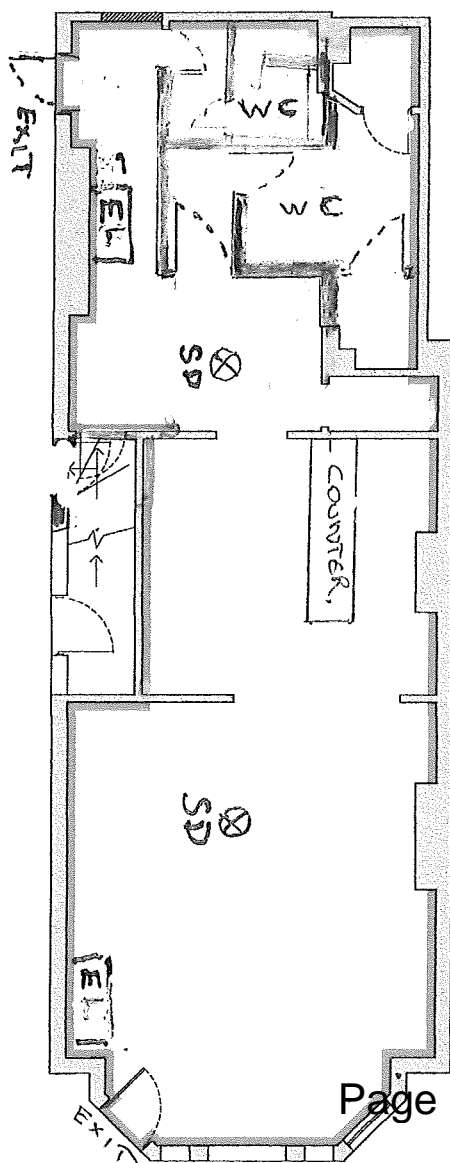

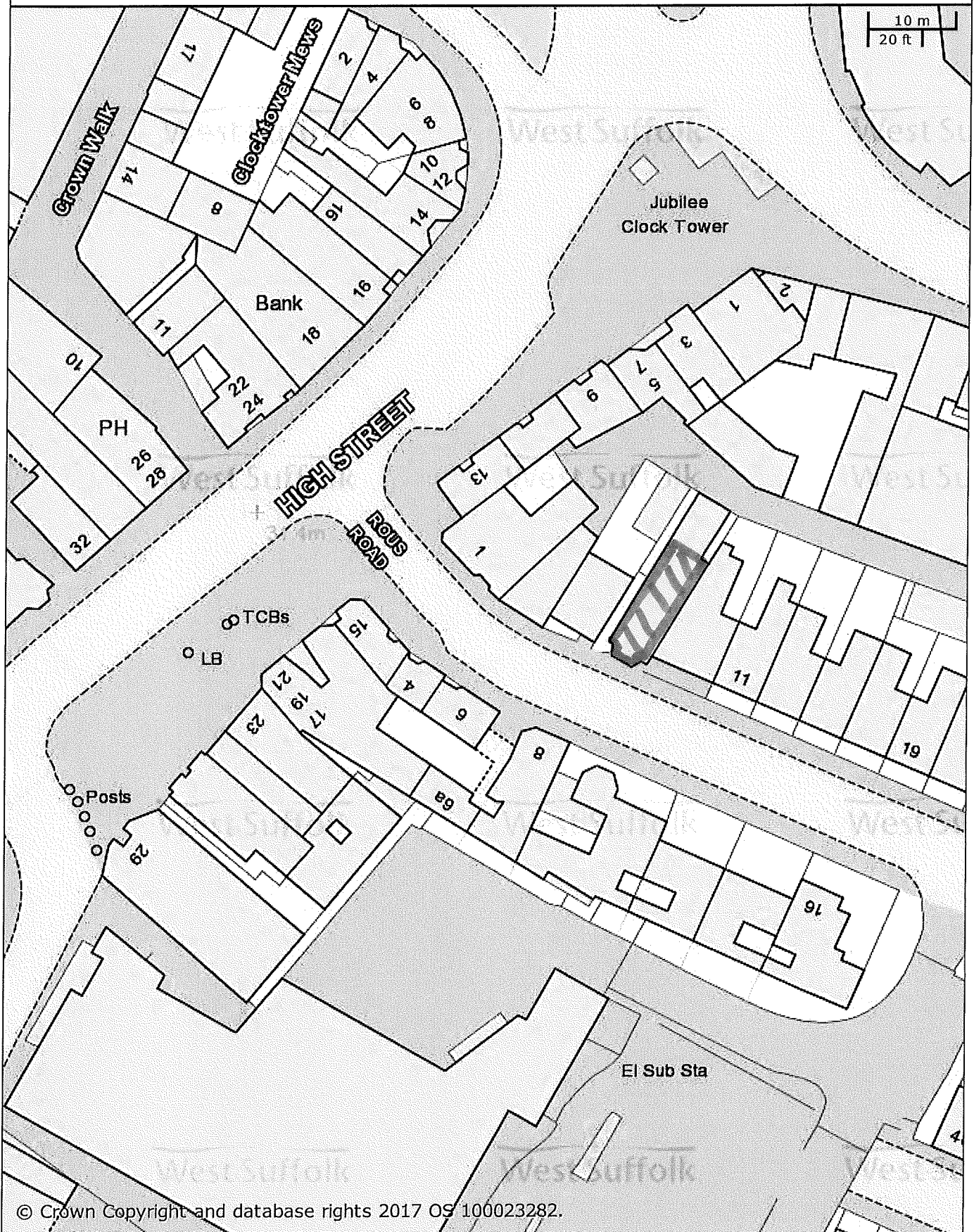

**Black Bess**

© Crown Copyright and database rights 2017 OS 100023282.

St Edmundsbury BC  
Western Way  
Bury St Edmunds  
IP33 3YU  
01284 763233

Forest Heath & St Edmundsbury councils  
**West Suffolk**  
working together  
[www.westsuffolk.gov.uk](http://www.westsuffolk.gov.uk)

Forest Heath DC  
College Heath Road  
Mildenhall  
IP28 7EY  
01638 719000

Scale: 1:600

Printed on: 7/8/2017 at 11:41 AM by SGowans

© Crown Copyright and database rights 2017  
OS 100023282/100019675.

This page is intentionally left blank

**Gowans, Sheila**

---

**From:** Lara Kinnett <  
**Sent:** 15 August 2017 11:11  
**To:** licensing  
**Subject:** Licencing team - Black Bess - 7 Rous Rd, Newmarket - Representation

Hello

I am writing to represent myself, as the owner of the property neighbouring no.7. I own no. 5, 5a and 5b Rous Rd.

I am never against any small business wanting to improve our town but I have many concerns for this type of business next to my property and my own Business, Lara B. Lara B is a high end bridal boutique and has been in it's location for 12 years now. The type of business is a personal one, using calm relaxing music and it's location was chosen, as it is central but a quiet road. It is not a high footfall boutique and mainly by appointment only. I also have tenants in the property above and below. The tenants chose the location due it's it quiet surroundings too! I appreciate I can never be content with what is around me, but being a residential road and being surrounded by other higher end business, makes the location nice and quiet and more suitable. A pub style business is more suited when surrounded by other businesses, so it doesn't disrupt residents.

The concerns I have are not for the cafe application of Black Bess but the pub licence they are trying for. My business closes at 5pm most days, so my bridal business should not be affected much by the noise pollution this type of business will bring in an evening. However, I do have tenants as part of my business, who will be greatly affected. If I loose the tenants due to accelerated noise levels, then I also wont find new ones easily. Who wants to live next to a pub!

I have real concerns for crime too. I had a window smashed in June this year, due to a rowdy, drunken crowd, coming from the pubs off the high street. I had another a few years back too, so goodness knows how much of this I will get with a pub right next door. Even if the pub has a sophisticated clientele, it wont stop other's visiting , especially the hustle and bustle of Race nights and racing days. As the pub space isnt big inside they will drift onto the pavements and cause more noise and disruption locally. Alcohol causes disruption and I am very worried if this is an earlier disruption while my boutique is open. Their customers could start to linger outside and make noise and even lean on my railings, or sit on my steps of the shop. It has been seen before!

The nuisance of rowdy people and just crowds of people will cause the daily running of Lara B to loose it's high end experience to fail. The private nature of the running of the shop is perfect right now. I would have to some how change the format using maybe a 'shut door' policy and also make changes to the front large bay window to keep it more private. Race days will bring crowds of a certain clientele into the pub before it starts, in otherwise earlier in the day. This will disrupt my busiest day being Saturdays. The type of customer they are wanting to attract will need to spend more and so they will but they will also drink more as they will be able to afford it too! I am EXTREMELY concerned for the extra smoking too. The smoke will waft in, as it already does occasionally, due to the people standing outside while being at the pub. Then comes the butts left behind!

Public safety in a residential street with young families would mean the location of such a business completely unsuitable. I get young children/babies come to the shop too, so having crowds at times outside, will not be nice and could make people feel inferior and unsafe. I can't object on these terms really as it will not hopefully effect me badly but I make that case for the residents of the quiet street.

I wonder too how they will store their bins. Obviously bins with beer and food will smell! The passage running down the side of the property is already over run and crowded with bins by residents living above and around 7 Rous rd. There is only just enough room for residents to walk past the bins and larger bins will not fit? The back track down to 3-5 Rous rd is a 'Right of way' access to their parking and the corner parking at the back of 1-3 Rous rd, is private property, so there is no access at the back for bins and deliveries? With excessive parking issues along the street, I can't see how this type of business will be allowed. The local council, already have parking issues. Also where can the daily deliveries be made to such a business with no parking zones allocated to it? No clear drop off area's on a highly congested, narrow street??

I feel the pub part of this licence completely un-acceptable with my points above as reason. However, I have no objection for a cafe with closing hours being no later than 5.30pm of an afternoon.

I'd also like to highlight, that I have not been formally informed of this application. I actually found it by a Facebook link to the Cambridge news. Why has the local council not informed neighbours?

Please could you let me know you have received this representation.

Regards Lara Kinnett BA(Hons) Lara B Proprietor Rous Road, Newmarket, CB8 8DH

This page is intentionally left blank

\_\_\_/\_\_\_/2017

Name: KEVIN ANDERSON  
 Address: ROUS ROAD  
NEWMARKET  
CB8 8DH

Business Regulation and Licensing Team  
**Forest Heath District Council**  
 College Heath Road, Mildenhall,  
 Suffolk, IP28 7EY  
 Phone: 01638 719733  
 email: [licensing@westsuffolk.gov.uk](mailto:licensing@westsuffolk.gov.uk)

**RE. BLACK BESS 7 ROUS ROAD, NEWMARKET CB8 8DH / GRANT OF A PREMISES LICENCE**

To whom it may concern,

I / ~~We~~ object to the following licence application: Black Bess Coffee and Craft Beer Micro Pub/Café at 7 Rous Road Newmarket CB8 8DH.

Reason(s) for objections:

LICENSING OBJECTIVE	REASON FOR REPRESENTATION
PREVENTION OF CRIME AND DISORDER	ROUS ROAD IS ESSENTIALLY A RESIDENTIAL STREET OUTSIDE OF NORMAL BUSINESS HOURS. THIS APPLICATION WILL MEAN ALL THE NEGATIVE ASPECTS OF AN ALCOHOL BUSINESS TO IMPACT RESIDENTS THROUGHOUT THE EVENING.
PREVENTION OF PUBLIC NUISANCE	
PROTECTION OF CHILDREN FROM HARM PUBLIC	
PUBLIC SAFETY	

I/We KEVIN ANDERSON, hereby declare that all the information I have submitted is true and correct.

Signed: \_\_\_\_\_

Dated: 13/8/17

**Please send the completed form to the local authority area:**

Business Regulation and Licensing Team  
**Forest Heath District Council**  
College Heath Road  
Mildenhall  
Suffolk  
IP28 7EY

11 / 8 / 2017

Name: Mr L. RYAN  
 Address: Rous Road  
Newmarket  
Suffolk CB8 8DH.

Business Regulation and Licensing Team  
**Forest Heath District Council**  
 College Heath Road, Mildenhall,  
 Suffolk, IP28 7EY  
 Phone: 01638 719733  
 email: [licensing@westsuffolk.gov.uk](mailto:licensing@westsuffolk.gov.uk)

**RE. BLACK BESS 7 ROUS ROAD, NEWMARKET CB8 8DH / GRANT OF A PREMISES LICENCE**

To whom it may concern,

I / We object to the following licence application: Black Bess Coffee and Craft Beer Micro Pub/Café at 7 Rous Road Newmarket CB8 8DH.

Reason(s) for objections:

LICENSING OBJECTIVE	REASON FOR REPRESENTATION
PREVENTION OF CRIME AND DISORDER	Rous Road is a residential street with a few businesses opening between 8am - 7pm. Alcohol will cause disorders & where are the smokers going to congregate? ultimately on the street.
PREVENTION OF PUBLIC NUISANCE	Noise from smokers, drinkers & music will disturb the neighbourhood.
PROTECTION OF CHILDREN FROM HARM PUBLIC	Children live in the road & will have to walk passed, where above points will be applicable.
PUBLIC SAFETY	Above points. There are other empty premises on High Street which are more suitable for this type of business (pub).

Parking is already a huge issue, where are the patrons & visitors to this business going to park.

I/ We LAURIE RYAN., hereby declare that all the information I  
have submitted is true and correct.

Signed: \_\_\_\_\_

Dated: 11/8/17.

**Please send the completed form to the local authority area:**

Business Regulation and Licensing Team  
**Forest Heath District Council**  
College Heath Road  
Mildenhall  
Suffolk  
IP28 7EY



09/08/2017

Mr and Mrs Cameron Haynes  
Rous Road, Newmarket  
Suffolk CB8 8DH

Business Regulation and Licensing Team  
**Forest Heath District Council**  
College Heath Road, Mildenhall,  
Suffolk, IP28 7EY  
Phone: 01638 719733  
email: [licensing@westsuffolk.gov.uk](mailto:licensing@westsuffolk.gov.uk)

**RE. BLACK BESS 7 ROUS ROAD, NEWMARKET CB8 8DH / GRANT OF A PREMISES LICENCE**

To whom it may concern,

We object to the following licence application: Black Bess Coffee and Craft Beer Micro Pub/Café at 7 Rous Road Newmarket CB8 8DH.

Reason(s) for objections:

<b>LICENSING OBJECTIVE</b>	<b>REASON FOR REPRESENTATION</b>
<b>PREVENTION OF CRIME AND DISORDER</b>	<p>We believe that a micro pub on our road will encourage drunk and disorderly behaviour on our doorstep. There are particular times of the year, for example during race weekends, horse sales and concert nights, when there is an increase in drunk revellers shouting, fighting and leaving cans, bottles and take away rubbish on our street.</p> <p>A micro pub on Rous Road will surely exacerbate the problem.</p> <p>The alleyway adjacent to the premises (7 Rous Road), which leads to the back of some of the houses on Rous Road, is another cause for concern. It could potentially be used as a public toilet when the business closes. There is also the issue of security if it should become used as a frequent shortcut between Station Road and Rous Road.</p>
<b>PREVENTION OF PUBLIC NUISANCE</b>	<p>There will be an increase in the level of noise due to music being played on the premises. The application to do so until 23:00 on weekdays and 23:30 on Fridays and Saturdays, will disturb the residents on what is otherwise a quiet road in the evenings. There could be an increase in anti-social behaviour as a result of alcohol being consumed on the premises. There is also the issue of smoking on Rous Road, as the business will find it very difficult to designate a smoking area, as the property has restricted outside space. This will result in the business's clients, spilling onto the road and alleyway. There will be litter as a result, and currently there is very poor street cleaning which means that further litter could become a problem.</p> <p>The parking situation on Rous Road, which has failed to be resolved over the last few years, is also a cause for concern. As residents, we already find it difficult to park at all times of the day. There is potential for an increase in cars parking on Rous Road where we already suffer as a result of having no residential parking.</p>



12/8/2017

Forest Heath DC
18 AUG 2017
Mildenhall

Name: C. COOMBE S  
 Address: ROUS RD  
NEWMARKET  
CB8 8DH

Business Regulation and Licensing Team  
**Forest Heath District Council**  
 College Heath Road, Mildenhall,  
 Suffolk, IP28 7EY  
 Phone: 01638 719733  
 email: [licensing@westsuffolk.gov.uk](mailto:licensing@westsuffolk.gov.uk)

**RE. BLACK BESS 7 ROUS ROAD, NEWMARKET CB8 8DH / GRANT OF A PREMISES LICENCE**

To whom it may concern,

☒ We object to the following licence application: Black Bess Coffee and Craft Beer Micro Pub/Café at 7 Rous Road Newmarket CB8 8DH.

Reason(s) for objections:

LICENSING OBJECTIVE	REASON FOR REPRESENTATION
PREVENTION OF CRIME AND DISORDER	WE DONT NEED AN OFF LICENCE IN ROUS RD - THERE ARE ENOUGH PUBS IN THE NEAR VICINITY THERE WILL BE LATE NIGHT NOISE AND WITH ALCOHOL COMES DISORDER. THE AREA WILL BE USED AS A TOILET. CARS WILL BE
PREVENTION OF PUBLIC NUISANCE	VANDALISED, SHOUTING, DRUNKEN BEHAVIOUR, FIGHTS, LANGUAGE ETC! GARDENS USED TO DUMP RUBBISH. IT ALL FOLLOWS WHERE BOOZ IS CONCENTRATED. WE ARE OLD
PROTECTION OF CHILDREN FROM HARM PUBLIC	AND WE NEED THE PEACE AND QUIET. THAT WE DESERVE AT THIS TIME IN OUR LIFE. THIS IS NOT THE RIGHT AREA TO OPEN THIS MICRO PUB.
PUBLIC SAFETY	WE ALL DO NOT LIKE LOUD RUBBISH SO CALLED RUBBISH MUSIC AT ANY TIME DAY OR NIGHT

We C. COMBES, hereby declare that all the information I  
have submitted is true and correct.

Signed: \_\_\_\_\_

Dated: 12-8-17

**Please send the completed form to the local authority area:**

Business Regulation and Licensing Team  
**Forest Heath District Council**  
College Heath Road  
Mildenhall  
Suffolk  
IP28 7EY

11 / 08 / 2017

Name: Mr + Mrs P Gwell  
 Address: Rous Road  
Newmarket  
Suffolk - CB8 8DH.

Business Regulation and Licensing Team  
**Forest Heath District Council**  
 College Heath Road, Mildenhall,  
 Suffolk, IP28 7EY  
 Phone: 01638 719733  
 email: [licensing@westsuffolk.gov.uk](mailto:licensing@westsuffolk.gov.uk)

**RE. BLACK BESS 7 ROUS ROAD, NEWMARKET CB8 8DH / GRANT OF A PREMISES LICENCE**

To whom it may concern,

*X* We object to the following licence application: Black Bess Coffee and Craft Beer Micro Pub/Café at 7 Rous Road Newmarket CB8 8DH.

Reason(s) for objections:

LICENSING OBJECTIVE	REASON FOR REPRESENTATION
PREVENTION OF CRIME AND DISORDER	we are long term and now elderly residents on Rous Road - As neighbours to this property which was a hair dresser for years with normal business hours, we strongly object to (and with police cuts how can an extra public house be policed)
PREVENTION OF PUBLIC NUISANCE	The Potential problem(s) that come with Drinking establishments in/off a main high st where there are many public houses already plus litter in the form of cigarettes, broken glass etc. As the adjoining property to No. 7, the level of noise from music as well as people late at night would be unsuitable due to the major lack of sound proofing in these buildings
PROTECTION OF CHILDREN FROM HARM PUBLIC	Though just off the main high street this is a very residential area, and safe area for children and other members of the community/public - we feel that another potentially loud & late opening public house would affect this.
PUBLIC SAFETY	Apart from the obvious side effects which come with groups of people drinking in a small property which can lead to disputes, aggression, fighting and general disorder, there is the physical damage that can be caused to parked vehicles and other property - as well as injuries from broken glass on public highway and littering from discarded cigarettes. As well as the possibility of someone who has had a few drinks accidentally wandering in front of a car or into a pedestrian

I/We PATRICK COWELL CONSULTATION  
COWELL hereby declare that all the information I  
have submitted is true and correct.

Signed: \_\_\_\_\_

11/8/17

Dated: 11<sup>th</sup> August 2017

**Please send the completed form to the local authority area:**

Business Regulation and Licensing Team  
**Forest Heath District Council**  
College Heath Road  
Mildenhall  
Suffolk  
IP28 7EY

P.S. There are many other aspects which should be strong grounds to refuse the change of use and licensing of this property but the main reason we believe this would be a bad decision if granted has to be not just the properties location which is residential above the ground floor, and residential to the left and to the right of the property, but also due to the size of the premises which would raise public safety & fire safety concerns for a premises of this size and with the 'bedsit' accommodation above could lead to a very unfortunate and dangerous situation in the future, due to lack of fire exits etc. etc.

P.T.O.

Also due to the nature of the alleyway and access at the back of the properties we from past experience can see people using it as an area for public convenience.

Plus there are plenty more suitable properties on the high st. which not only would be more suitable for a licensed establishment but also are better fit for the purpose.

<

/

11/8/17





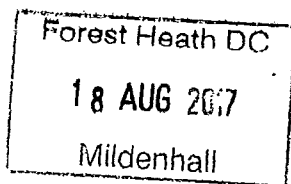

12/08/2017

NAZ JACKSON &  
 Name: PATRICK COWELL  
 Address: ROUS ROAD, NEWMARKET  
SUFFOLK, CB8 8DL

Business Regulation and Licensing Team  
**Forest Heath District Council**  
 College Heath Road, Mildenhall,  
 Suffolk, IP28 7EY  
 Phone: 01638 719733  
 email: [licensing@westsuffolk.gov.uk](mailto:licensing@westsuffolk.gov.uk)

**RE. BLACK BESS 7 ROUS ROAD, NEWMARKET CB8 8DH / GRANT OF A PREMISES LICENCE**

To whom it may concern,

I / We object to the following licence application: Black Bess Coffee and Craft Beer Micro Pub/Café at 7 Rous Road Newmarket CB8 8DH.

Reason(s) for objections:

LICENSING OBJECTIVE	REASON FOR REPRESENTATION
PREVENTION OF CRIME AND DISORDER	We have a long running business on Rous Road, which we make sure does not encroach on the residents lives in any negative way.
PREVENTION OF PUBLIC NUISANCE	As seen often in Newmarket, when drinking alcohol is involved, there is always loud arguments, fights and damage to public property. These establishments should be kept on the high street.
PROTECTION OF CHILDREN FROM HARM PUBLIC	As a respectable and mostly residential neighbourhood, the late license for music and alcohol will indefinitely cause frustration and intrusion into the residents of Rous Road.
PUBLIC SAFETY	Children of Rous Road feel safe playing in their front gardens and suffer from little disturbance from those who are on the high street. This establishment will no doubt change their safety. With groups of people smoking, drinking and sometimes arguing, we are very concerned for the residents safety, especially our parents who live right next door to the proposed business. Broken glass, violent drunks, the list goes on.

Littering will become an issue, using the alley way as a toilet will become another issue. Residents trying to sleep with the music on past 11pm 7 days a week and the voices of punters too. Will be a huge issue.

We PATRICK COWELL - NAZ JACKSON, hereby declare that all the information I have submitted is true and correct

Signed

Dated: 12 August 2017

**Please send the completed form to the local authority area:**

Business Regulation and Licensing Team  
**Forest Heath District Council**  
College Heath Road  
Mildenhall  
Suffolk  
IP28 7EY

**Gowans, Sheila**

---

**From:** Pat Cook  
**Sent:** 19 August 2017 19:43  
**To:** licensing  
**Subject:** Representations re: Black Bess - 7 Rous Road, Newmarket

Dear Sir / Madam,

I write as a resident of Rous Road to set out my concerns in respect of the application by Mr Turpin for the proposed licence for Black Bess Coffee and Craft Beer Micro Pub / Cafe.

Whilst I am a supporter of small and local businesses, I am worried that a pub at the end of the road would affect the quality of life for local residents. The space where number 7 Rous Rd is is very small and I consider that it is likely that people smoking and drinking on the pavement outside the pub will make it difficult for people (especially the very young and the elderly) to pass as the pavement is already quite narrow. Additionally it is incredibly difficult to find parking as it is in Rous Road and I fear that further demand for parking spaces and additional traffic in the road will make things more difficult for the residents.

I am also worried that the consumption of alcohol and loud music late at night will inevitably cause nuisance and attendant anti social behaviour.

I would support the opening of a cafe serving teas and coffees (as set out in part of the application) but I am unable to support that premises serving alcohol for the reasons set out above. I understand that many of my neighbours share similar concerns to me.

I do hope that these representations will be taken in to account when considering this application.

Yours faithfully,

Patricia Cook.  
Rous Road  
CB8 8DL

Sent from my iPad

This page is intentionally left blank

**Gowans, Sheila**

---

**From:** James Long <James.Long@corneyandbarrow.com>  
**Sent:** 21 August 2017 11:31  
**To:** licensing  
**Cc:** Gil Riggans  
**Subject:** RE: Premises License Application: Black Bess, 7 Rous Road, Newmarket, CB8 8DH

Dear Sirs

Following your response, we would like to re-submit our objections regarding this application as follows:

- The prevention of crime and disorder: As a residential area, this type of license could increase the possibility of crime and, with the association of alcohol, disorder would certainly be present and therefore a hazard for residents during and following the proposed opening times.
- Public safety could also be a risk if alcohol is being consumed in a residential area during and following the proposed opening times.
- The prevention of public nuisance: As mentioned above, any possible disorder from this style of venue could become a nuisance to residents. There would also be an increase in the noise of traffic and patrons attending the premises, not only during opening hours but also for deliveries etc.

Looking at all three of the above concerns, with the current cuts to services there is already insufficient police presence at present within this area. With the possible threat of increased crime levels, disorder and public nuisance, the Police Services may not have sufficient resources to govern an additional venue with its location being in a residential area. This gives great concern to residents and indeed the security of our own shop, Corney & Barrow, which can be accessed from the rear.

We trust that our concerns, along with the residents of Rous Road are taken into consideration with regards to this application.

With kind regards

James

**JAMES LONG**

Managing Director

T +44 (0)1638 600000

M +44 (0)7836 230432

E [james.long@corneyandbarrow.com](mailto:james.long@corneyandbarrow.com)

[www.corneyandbarrow.com](http://www.corneyandbarrow.com)

**CORNEY &  
BARROW**

INDEPENDENT WINE MERCHANTS-1780

This page is intentionally left blank

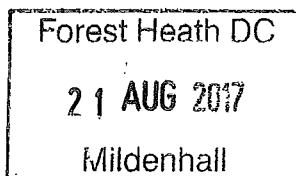

7 ROWS ROAD  
NEWMARKET  
SUFFOLK  
CB8 8DL.

August 17<sup>th</sup> 2017

THE BUSINESS REGISTRATION + LICENSING TEAM  
FOREST HEATH DISTRICT COUNCIL  
COLLEGE HEATH ROAD  
MILDENHALL IP28 7EY.

TO WHOM IT MAY CONCERN,

RE: 'BLACK BESS', 7, ROWS ROAD NEWMARKET

GRANT OF A PREMISES LICENCE.

WE WISH TO OBJECT TO THE ABOVE LICENSING  
APPLICATION ON THE FOLLOWING GROUNDS.

- ①. THE PREMISES IS ATTACHED TO A SUBSTANTIAL  
HOUSE IN WHAT IS MAINLY A RESIDENTIAL STREET.
- ②. THE ANTI-SOCIAL BEHAVIOUR WHICH WILL OCCUR  
IN NEARBY DOORWAYS + PASSAGEWAYS.
- ③. LOUD MUSIC IN A RESIDENTIAL STREET IS  
UNACCEPTABLE.

This page is intentionally left blank



14/8/2017



Name: MR AND MRS M JEFFERY  
 Address: ROUS ROAD  
NEWMARKET  
CB8 8DH

Business Regulation and Licensing Team  
**Forest Heath District Council**  
 College Heath Road, Mildenhall,  
 Suffolk, IP28 7EY  
 Phone: 01638 719733  
 email: [licensing@westsuffolk.gov.uk](mailto:licensing@westsuffolk.gov.uk)

RE. **BLACK BESS 7 ROUS ROAD, NEWMARKET CB8 8DH / GRANT OF A PREMISES LICENCE**

To whom it may concern,

I / We object to the following licence application: Black Bess Coffee and Craft Beer Micro Pub/Café at 7 Rous Road Newmarket CB8 8DH.

Reason(s) for objections:

LICENSING OBJECTIVE	REASON FOR REPRESENTATION
PREVENTION OF CRIME AND DISORDER	ROWDINESS AND DISORDER CAUSED BY ALCOHOL CONSUMPTION LATE INTO THE NIGHT, POSSIBLE DAMAGE CAUSED TO RESIDENTS VEHICLES PARK ON ROUS ROAD
PREVENTION OF PUBLIC NUISANCE	PARKING PROBLEMS (WHICH WE ALREADY HAVE) MUSIC BEING PLAYED LATE (HAVE) AT NIGHT IN A RESIDENTIAL AREA.
PROTECTION OF CHILDREN FROM HARM PUBLIC	As this is a residential area there are children growing up. So there are the dangers of broken glass, people smoking, possibly drug
PUBLIC SAFETY	taking, litter, cigarette ends. We cannot believe this application is even being considered.

I/ We MR & MRS M & SV JEFFERY, hereby declare that all the information I have submitted is true and correct.

Signed

Dated: 16-8-17

**Please send the completed form to the local authority area:**

Business Regulation and Licensing Team  
**Forest Heath District Council**  
College Heath Road  
Mildenhall  
Suffolk  
IP28 7EY

17/08/2017

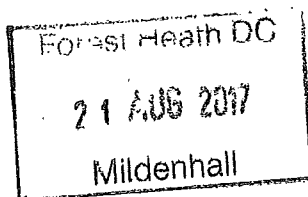

Name: MRS M.A. VAN DER WERFF  
 Address: ROUS ROAD  
NEWMARKET  
CB8 8DL

Business Regulation and Licensing Team  
**Forest Heath District Council**  
 College Heath Road, Mildenhall,  
 Suffolk, IP28 7EY  
 Phone: 01638 719733  
 email: [licensing@westsuffolk.gov.uk](mailto:licensing@westsuffolk.gov.uk)

RE. **BLACK BESS 7 ROUS ROAD, NEWMARKET CB8 8DH / GRANT OF A PREMISES LICENCE**

To whom it may concern,

I / ~~We~~ object to the following licence application: Black Bess Coffee and Craft Beer Micro Pub/Café at 7 Rous Road Newmarket CB8 8DH.

Reason(s) for objections:

LICENSING OBJECTIVE	REASON FOR REPRESENTATION
PREVENTION OF CRIME AND DISORDER	This is a quiet residential road. There is no need for another 'beer outlet cafe' when we have so many on the High Street
PREVENTION OF PUBLIC NUISANCE	Music would create a nuisance.
PROTECTION OF CHILDREN FROM HARM PUBLIC	Several young children and elderly people live in the road.
PUBLIC SAFETY	The High Street end of Rous Road is already often blocked with cars parked illegally to access Rumbles Fish Shop on the High Street so that we cannot exit by vehicle onto the High Street

and an emergency vehicle could not gain access. granting a licence would exacerbate this problem.

I/ Me, hereby declare that all the information I  
have submitted is true and correct.

Signed:

Dated: 17<sup>th</sup> August 2015

**Please send the completed form to the local authority area:**

Business Regulation and Licensing Team  
**Forest Heath District Council**  
College Heath Road  
Mildenhall  
Suffolk  
IP28 7EY

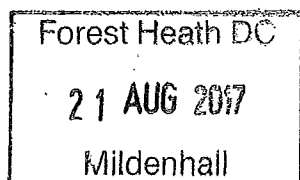

Rous Road  
Newmarket  
Suffolk  
CB8 8DB  
07961854013  
01638 664 793

15<sup>th</sup> August 2017

Forest Heath District Council  
College Heath Road  
Mildenhall  
Bury St Edmunds  
Suffolk  
IP28 7EY  
[www.westsuffolk.gov.uk](http://www.westsuffolk.gov.uk)

Dear Licensing Committee

RE: Applicant Marcus Turpin  
Premises Address: Black Bess 7 Rous Road, Newmarket CB8 8DH  
Application Type: Grant of a Premises Licence Summary of Application:

I am writing with regard to the consultation on the above application. I am a resident of Rous Road with young children. I have no objection to the change of use of these premises to a café. However, I have grave reservations regarding the application of change of usage to a pub.

The reasons supporting my objections are as follows:

Newmarket has undergone an extensive analysis of the impact of a high concentration of licensed premises on its town centre. This resulted in the Cumulative Impact Policy in which it states that, "the Licensing Authority has resolved to adopt a policy which will seek to prevent a further increase in the number of licensed premises within the area outlined in red on the plan within this document (section 9.5)." I have attached a copy of the map to this letter. The applicant's premises fall just beyond the policies remit by a matter of metres. The policy does not include areas which were considered residential and thus unsuitable for licenced premises.

To grant the application would be in essence contravening the statement set out in section 9.9 of the Licensing Act 2003 Statement of Licensing Policy (4th Edition) 2014 – 2019 that "The Licensing Authority wishes to encourage the provision of a range of entertainment in the area and to reduce the dominance of pubs, bars and nightclubs. Any future expansion of licensed premises/night time economy should be consistent with the wider regeneration aspirations of the Council and its partners and should actively promote an inclusive town centre for all that is a safe and pleasant place to be in". This is further expanded in section 9.10 "The proposals in respect of the town centre are intended to target those premises that will increase the numbers of customers in the area and those premises serving alcoholic drinks and/or takeaway food after 11:00pm that can act as a flash point for crime and disorder and public nuisance. It is not intended to constrain the development of other entertainment uses which do not add to the problems being experienced in this area". In

section 9.11 it states that it "is the Licensing Authority's policy that there will be a rebuttable presumption that applications for new premises licences or club premises certificates, which are primarily drinking establishments and are premises used primarily or exclusively for the sale and consumption of alcohol, will be refused if relevant representations are received about the cumulative impact on the licensing objectives."

My second objection focuses on the cumulative impact (as defined by section 9 of the Licensing Act 2003 Statement of Licensing Policy (4th Edition) 2014 – 2019) that agreeing this license will have on a residential area. In daytime hours Rous Road forms part of the busy hub of Newmarket with the Rous Road car park and a few specialist shops as you enter the road from the high street. In the late afternoon, when the shops are closed, the nature of Rous Road changes. Although being next to the high street from the evening onwards it is a quiet residential road. The Cumulative Impact Policy covers up to Courtney and Barrow (a specialist off licence) the remainder of the road is not considered to part of the Newmarket night time or licencing economy. There is little foot traffic from the high street in the evening as the bars are secured, well monitored and contained on the High Street. Consequently, there is no draw for people engaging in the night time economy to enter Rous Road and it is unusual for people to do so. Introducing a pub will change the nature of the street irrevocably and alter the dynamic of the successful high street policy which protects the local community.

Parking in Rous Road is a continual difficulty and it is unlikely that the premises will impact on this significantly. However, the street near the premises is on a dangerous junction which is made more dangerous by the parking situation. Having a licenced premise and the increase in people will add to this congestion and impact significantly on the likelihood of accidents. In particular for the young and older people of the area who may well feel uncomfortable being near a licenced premise when crossing the road.

I look forward to hearing your decision.

Yours faithfully

Dr Victoria Richer

**Gowans, Sheila**

---

**From:** Audrey Lewis  
**Sent:** 21 August 2017 13:11  
**To:** licensing  
**Subject:** Objection to: Black Bess. 7 Rous Road Newmarket. Suffolk. CB8 8DH

From  
Audrey Lewis  
7, Rous Road  
Newmarket  
Suffolk  
CB8 8DH

The Business Regulation and Licencing Team.  
I object to the above application on the grounds of your criteria.

**1. Rous Road is a conservation area, suitable for 09.00 -17.30 /19.00 businesses.**

for example, hair, beauty, offices, clothes, interiors. These types do not generate noise, flue stench, traffic nuisance or drunk and drug filled clientele as the proposed will do.

**2. The former Pizza shop, all be it nice, had constantly boarded-up windows.**

This was due to the drunks and unsavoury people it attracted with late opening. This will repeat if Black Bess is allowed to trade. This reflects badly on our businesses and residents. It is also very frightening.

**3. There are several empty shops in the high street which are a more fitting place for Black Bess.**

**4. Anti social behaviour will be encouraged.**

The weed ridden, uneven, broken tiled, unkempt adjacent side alley which leads to the rear of our properties - will become an area for urination, smoking, sexual acts and drug taking. The rear of our premises becoming vulnerable to vandalism including our bins. A gate will be no deterrent.

**5. All businesses in Rous Road are subject to closing by 7/8 pm to protect the well being, health and safety of the residents.**

Why should Black Bess have special treatment when granting a licence will be so detrimental to our health etc and our children's safety?

**6. Public nuisance.**

I had rented the entire middle floor of 7, Rous Road for 4 years and for 26 yrs have lived and worked at no 25. THE WALLS ARE THINNER THAN YOU THINK!!! (Clients also often remark).

All these sounds can be heard from neighbouring properties:-

Switches - on/off, appliances (Note: professional coffee makers are especially noisy), boilers etc., cupboard doors opening / closing, ALL toilet functions - defecation and urination. (This is quite TRUE), laughter, raised voices (as bars fill-up music levels are raised & voices are raised too), fighting, music & musical instruments, doors closing / slamming, TVs, walking up stairs, wooden floors.

**It is fact that sound proofing does NOT work. (B.B.C. documentary 2016).**

**7. Emptying of bottles / rubbish to outside bins**

This is very noisy and will be too close to our homes.

**8. Sound carries at night and on the wind.**

Rous Road is S/W facing and windy that side, all Black Bess noise / music will carry down the road, as does the Night Racing music, so it would be too noisy for the residents  
S/W facing = lots of summer heat from 11am. Our rooms stay hot. Windows must be opened.

**9. Public noise on entering and leaving + music will be too noisy.**

Whilst B/Bess's windows may be closed, doors are opened.

Please consider when we are ill and need quiet.

(You will be receiving a complaint, with an offer of compromise, regarding a near by pub relating to noise, therefore one in our road will always be a public nuisance etc.

**10. The maintenance of no. 7 was always very poor - electrical and general.**

I do not think a food and drink establishment is a safe environment. Check your records Sept 1989 to 1991 approx. The current condition of the alley way, doors and outer condition bears me out.

**11. Licensing Extensions**

Once established Christmas and New Year extensions will be applied for plus additional days.

**12. Public Health.**

The smell from Rumble's Fish Bar in the High Street and the Chinese take away in Old Station Road are nauseating at times. This spoils relaxation time in our gardens or if our windows are open. A food establishment in our road will be very unpleasant as it will be just a few feet away.

**13 General litter will increase.**

As a member of The Retailers Association I know that businesses will not clear away their litter and bottles. Late night establishments attract this problem. I clear Rous Road at times. I do not wish to see more rubbish in the road.

**14 Congestion = Public Safety.**

Despite the car park in Rous Road, it is a known fact that people are lazy. They continually park, double park and pavement park on the corner by the high street and in front of no.7. Poor signage and policing contribute to this.

**14a Black Bess will be serviced by large refrigerated lorries.**

The extra vehicles will cause enormous congestion which will lead to dangerous situations to all who have to cross the road. The designated crossing area is often blocked. I have photo evidence. Existing businesses at this end add to this problem therefore Black Bess will be one too many = The Straw That Breaks The Camel's Back.

The cycle lane has escalated this problem.

**15 The Disabled.**

I have spoken to the blind citizens whom have to cross there. They are extremely worried at the prospect of more congestion. One such lady from Dutchess Drive said, "I have to struggle between the large vehicles, push out my stick and then take my life in my hands.

I am scared at the prospect service vehicles to Black Bess will cause." Guide dog owners echo this sentiment.

When accompanying minors, on foot or in a push chair, using shopping trolleys or motorised scooters it's impossible to cross there most times.

Please consider our blind users of Rous Road, other disabled citizens (wheel chair & motorised scooters), the elderly and our clients of whom some fall into this category.

Thank you.

Audrey Lewis (Miss).



Roudham  
East harling  
Norfolk  
NR16 2RL

22<sup>nd</sup> August 2017

Forest Heath District Council  
College Heath Road  
Mildenhall  
Bury St Edmunds  
Suffolk  
IP28 7EY

Dear Sir/Madam,

**Re: Licence application 7 Rous Road, Newmarket**

I am writing regarding the above application to grant a licence to sell alcohol at the above premises as I own a property in the road. Rous Road is a residential street just off the High Street. The High Street has many pubs, bars and cafes which cater for the needs of the town. There is no need to spoil a residential street by having premises that sells alcohol and will have opening hours late into the evening where families and children live.

Rous Road is not an appropriate site for this kind of business and I am sure there are more suitable sites available in Newmarket.

Yours faithfully,

Miss L Martin

This page is intentionally left blank

**Gowans, Sheila**

---

**From:** Audrey Lewis  
**Sent:** 21 August 2017 18:11  
**To:** licensing  
**Subject:** BLACK BESS. 7, ROUS ROAD NEWMARKET SUFFLOK CB8 8DH

Julie Bennett  
Dutchess Drive  
Newmarket  
Suffolk  
CB8 8AQ  
22nd August 2017

(Sent from the e-mail of)  
(Audrey Lewis.)

I object to the opening of a micro café/bar on the grounds of:-  
Prevention of public nuisance.  
Public safety.

I am a white cane user. Due to my disability, I dread the thought of a business operating that will cause added stress to my already troubled path down Rous Road.

Large vehicles tend to park on the pavement. This is especially difficult for me. It is more hazardous because the rubbish bins are always out and store wares which appear to be taking over the pavements. The official raised crossing area is often blocked.  
In order to cross the road I have to squeeze past tightly parked vehicles. I place my cane ahead of me and pray that I can be seen.

The path outside the shop is narrow. Smokers / drinkers will accumulate outside. This will increase my difficulty to pass by and is very intimidating not just to me but to others.  
Most of the businesses attract predominately a female clientele in Rous Road and such a premises could see a fall in trade for them.

A late night premise will increase litter. Bottles, especially broken ones are an extra hazard for me including users of wheel chairs and scooters.

Julie Bennett (Mrs.)

This page is intentionally left blank

**Gowans, Sheila**

---

**From:** Tolly Considine  
**Sent:** 21 August 2017 16:36  
**To:** licensing  
**Subject:** Black Bess 7 Rous Road, Newmarket CB8 8DH

Dear Sirs,

I write to you as the owner of , Rous Road Newmarket and the owner of TollysFlowers To object to this proposal of an alcohol license to the above address.

I see this as a damage to the residents and businesses of this road, (and particularly residents) it is a danger to have a late license for selling alcohol, when there are so many other places with in Newmarket that provided this service already.

Alcohol consumption, smoking on the street, leading to excessive noise, causing obstacles to wheelchair users, children, the elderly and disabled, also crime, I know my neighbour Lara B bridal has had her windows broken twice by drunks in the early hours of the morning, due to alcohol and drunkenness.

Traffic is all ready a major issue for Rous Road, this application will on make the issue much, much worse if this is granted.

Your Sincerely.

Tolly Considine.  
[www.tollysflowers.co.uk](http://www.tollysflowers.co.uk)  
Sent from my iPad

This page is intentionally left blank

17/7/2017

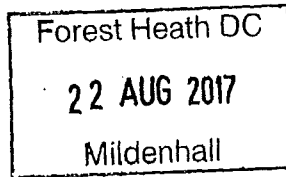

Name: Sarah Hensley  
 Address: Reas Rd  
Newmarket  
Suffolk  
CB8 8DH

Business Regulation and Licensing Team  
**Forest Heath District Council**  
 College Heath Road, Mildenhall,  
 Suffolk, IP28 7EY  
 Phone: 01638 719733  
 email: [licensing@westsuffolk.gov.uk](mailto:licensing@westsuffolk.gov.uk)

RE. BLACK BESS 7 ROUS ROAD, NEWMARKET CB8 8DH / GRANT OF A PREMISES LICENCE

To whom it may concern,

I / We object to the following licence application: Black Bess Coffee and Craft Beer Micro Pub/Café at 7 Rous Road Newmarket CB8 8DH.

Reason(s) for objections:

LICENSING OBJECTIVE	REASON FOR REPRESENTATION
PREVENTION OF CRIME AND DISORDER	Why use residential area when Newmarket has open shops along the High Street that would make great bars.
PREVENTION OF PUBLIC NUISANCE	Public Houses shut, every year use these not bringing noise, trouble
PROTECTION OF CHILDREN FROM HARM PUBLIC	e.g. to quiet streets.
PUBLIC SAFETY	NO outdoor space for smokers, so would lead to filling pathways. Intimidating residents.

along with noise, double parking e.g.  
 NO Sorry this is Page 57 recipe for disaster.

I/We S. L., hereby declare that all the information I  
have submitted is true and correct.

Signed: \_\_\_\_\_

Dated: 17-7-12

**Please send the completed form to the local authority area:**

Business Regulation and Licensing Team  
**Forest Heath District Council**  
College Heath Road  
Mildenhall  
Suffolk  
IP28 7EY



21/8/2017

Name: MR. D. H. BATTEN  
 Address: ROUS ROAD  
NEWMARKET

Business Regulation and Licensing Team  
**Forest Heath District Council**  
 College Heath Road, Mildenhall,  
 Suffolk, IP28 7EY  
 Phone: 01638 719733  
 email: [licensing@westsuffolk.gov.uk](mailto:licensing@westsuffolk.gov.uk)

**RE. BLACK BESS 7 ROUS ROAD, NEWMARKET CB8 8DH / GRANT OF A PREMISES LICENCE**

To whom it may concern,

I / We object to the following licence application: Black Bess Coffee and Craft Beer Micro Pub/Café at 7 Rous Road Newmarket CB8 8DH.

Reason(s) for objections:

LICENSING OBJECTIVE	REASON FOR REPRESENTATION
PREVENTION OF CRIME AND DISORDER	A drinking establishment in a residential road will lead to drunken behavior, and probable vandalism to property and or transport
PREVENTION OF PUBLIC NUISANCE	Smoking in street - loud music keeping residents awake all night.
PROTECTION OF CHILDREN FROM HARM PUBLIC	See above.
PUBLIC SAFETY	A pub/cafe should be in the High Street and not in a very sought after residential street like Rous Road. Property prices will almost certainly be hit.

I/We DAVID BATTEN, hereby declare that all the information I have submitted is true and correct.

Signed: \_\_\_\_\_

Dated: 21/8/2012

**Please send the completed form to the local authority area:**

Business Regulation and Licensing Team  
**Forest Heath District Council**  
College Heath Road  
Mildenhall  
Suffolk  
IP28 7EY

## Rous Road Residents Petition

<b>Petition summary and background</b>	<p>Black Bess 7 Rous Road, Newmarket CB8 8DH</p> <p>Application Type: Grant of a Premises Licence</p> <p>The premises will be a coffee and craft beer micro pub/café, specialising in small independently brewed beers and specialist coffee and teas.</p> <p><b>Licensable activities requested are:</b></p> <p>Recorded music Mon to Sat 11.00 to 23.00, Sun 12.00 to 23.00</p> <p>Sale of Alcohol for consumption on and off the premises –</p> <p>Mon to Thurs 11.00 to 23.15</p> <p>Fri to Sat 11.00 to 23.30 and Sun 11.00 to 23.00</p>
<b>Principle Contact</b>	Cameron Haynes – Rous Road, Newmarket, CB8 8DH
<b>Action petitioned for</b>	We, the undersigned, are residents of Rous Road and are concerned by the proposed opening of a micro pub/café on our street and believe it will be detrimental to our quality of life. We question the suitability of the premises and oppose a licence application for its intended use.

Printed Name	Signature	Address	Comment	Date
P. RIGGS		Belvoir House	Residential + proximity of	15/08
P. COOK		Rous Road.	Residential area	15/08
Carley Gajda		Rous Road.	Resident. area	15/08
M. COOK		Rous Rd.	DISRUPTION TO QUIET AREA	15/8/17
N. JACKSON		ROUS RD.	This will indefinitely cause disruption to a quiet and respectable neighbourhood with negative effects to house prices for residents.	15/8/17
S. IGNARSKI		Rous Rd	Residential area / noise disruption	15/8/17
P. V. L. GOWELL		Rous Rd	Residential Area - lack of parking - noise & extra litter etc.	15/8/17

Rous Road Residents Petition

<b>Petition summary and background</b>	<p>Black Bess 7 Rous Road, Newmarket CB8 8DH</p> <p>Application Type: Grant of a Premises Licence</p> <p>The premises will be a coffee and craft beer micro pub/café, specialising in small independently brewed beers and specialist coffee and teas.</p> <p><i>Licensable activities requested are:</i></p> <p>Recorded music Mon to Sat 11.00 to 23.00, Sun 12.00 to 23.00</p> <p>Sale of Alcohol for consumption on and off the premises –</p> <p>Mon to Thurs 11.00 to 23.15</p> <p>Fri to Sat 11.00 to 23.30 and Sun 11.00 to 23.00</p>
<b>Principle Contact</b>	Cameron Haynes – Rous Road, Newmarket, CB8 8DH
<b>Action petitioned for</b>	We, the undersigned, are residents of Rous Road and are concerned by the proposed opening of a micro pub/café on our street and believe it will be detrimental to our quality of life. We question the suitability of the premises and oppose a licence application for its intended use.

Printed Name	Signature	Address	Comment	Date
E. EDWARDS		ROUS RD	Quiet residential Street.	10/8/17
ISAAC HAYNES		Rous Road	Noise, unsuitable location	10/8/17
DON CANTRELL		ROUS ROAD	NOISE, LITTER AND QUIET RESIDENTIAL ROAD	14/8/17

Rous Road Residents Petition

<b>Petition summary and background</b>	<p>Black Bess 7 Rous Road, Newmarket CB8 8DH</p> <p><b>Application Type:</b> Grant of a Premises Licence</p> <p>The premises will be a coffee and craft beer micro pub/café, specialising in small independently brewed beers and specialist coffee and teas.</p> <p><b>Licensable activities requested are:</b></p> <p>Recorded music Mon to Sat 11.00 to 23.00, Sun 12.00 to 23.00</p> <p>Sale of Alcohol for consumption on and off the premises –</p> <p>Mon to Thurs 11.00 to 23.15</p> <p>Fri to Sat 11.00 to 23.30 and Sun 11.00 to 23.00</p>
<b>Principle Contact</b>	Cameron Haynes – Rous Road, Newmarket, CB8 8DH
<b>Action petitioned for</b>	We, the undersigned, are residents of Rous Road and are concerned by the proposed opening of a micro pub/café on our street and believe it will be detrimental to our quality of life. We question the suitability of the premises and oppose a licence application for its intended use.

Printed Name	Signature	Address	Comment	Date
J JONES		Rous Rd	Not suitable	14.8.17
M.A. VAN DER WERFF		Rous Road	Letter sent as well	15.8.17
S. Hornsby		Rous Road	Not suitable Plenty of old pubs to do up	15/8
SHEILA JEFFERY		ROUS ROAD	NOT SUITABLE AT ALL	16/8
M JEFFERY		ROUS ROAD	"	16/8
L. MARTIN		Rouse Rd.	Not suitable in this Rd at all	16/8

# Re. Premises Licence 7 Rous Road, Newmarket

## Rous Road Residents Petition

<b>Petition summary and background</b>	<p>Black Bess 7 Rous Road, Newmarket CB8 8DH</p> <p>Application Type: Grant of a Premises Licence</p> <p>The premises will be a coffee and craft beer micro pub/café, specialising in small independently brewed beers and specialist coffee and teas.</p> <p><b>Licensable activities requested are:</b></p> <p>Recorded music Mon to Sat 11.00 to 23.00, Sun 12.00 to 23.00</p> <p>Sale of Alcohol for consumption on and off the premises –</p> <p>Mon to Thurs 11.00 to 23.15</p> <p>Fri to Sat 11.00 to 23.30 and Sun 11.00 to 23.00</p>
<b>Principle Contact</b>	Cameron Haynes – Rous Road, Newmarket, CB8 8DH
<b>Action petitioned for</b>	We, the undersigned, are residents of Rous Road and are concerned by the proposed opening of a micro pub/café on our street and believe it will be detrimental to our quality of life. We question the suitability of the premises and oppose a licence application for its intended use.

Printed Name	Signature	Address	Comment	Date
ANDREW LANHAM		ROUS ROAD NEWMARKET	UNSUITABLE FOR RESIDENTIAL AREA. NO PUBLIC CONVENIENCE.	11/08/17
RAY THURSTON		do	AVAILABLE	do
PATRICK COWELL		ROUS ROAD NEWMARKET	As Above, plus Health & Safety, Fire safety, Public Safety - plus plenty of alternative properties available	11/8/17
Consulacion COWELL		Rous Road NEWMARKET	As Above Plus my husband is V. unwell	11/8/17
James Palmer		Glenmore House Exning	On a residential street. Really!	11/8/17
MARY DEVERING		Standard for Newmarket	As above	11/5/17
Rachel Herrera		Rous Rd	Resident w/ children	11/11/17
David Herrera		244 Rous Rd	limited parking	11/11/17

# Re. Premises Licence 7 Rous Road, Newmarket

## Rous Road Residents Petition

<b>Petition summary and background</b>	<p>Black Bess 7 Rous Road, Newmarket CB8 8DH</p> <p>Application Type: Grant of a Premises Licence</p> <p>The premises will be a coffee and craft beer micro pub/café, specialising in small independently brewed beers and specialist coffee and teas.</p> <p>Licensable activities requested are:</p> <p>Recorded music Mon to Sat 11.00 to 23.00, Sun 12.00 to 23.00</p> <p>Sale of Alcohol for consumption on and off the premises –</p> <p>Mon to Thurs 11.00 to 23.15</p> <p>Fri to Sat 11.00 to 23.30 and Sun 11.00 to 23.00</p>
<b>Principle Contact</b>	Cameron Haynes – Rous Road, Newmarket, CB8 8DH
<b>Action petitioned for</b>	We, the undersigned, are residents of Rous Road and are concerned by the proposed opening of a micro pub/café on our street and believe it will be detrimental to our quality of life. We question the suitability of the premises and oppose a licence application for its intended use.

Printed Name	Address	Comment	Date
David Herrera	Rous Rd	Resident w/ children limited parking	17/8/17
A.P. LEWIS.	ROUS RD NEWMARKET CB8 8DH	WALLS ARE THINNER THAN YOU KNOW ALL OTHERS HAVE TIME LIMIT OF 7PM	11/8/17
		NO OTHER BUSINESSES PLAY MUSIC AS WALKS TO TOWN DRUNKS USING ALLEY AS A TOILET	
ALAN GRIMWOOD	Weatherley Crescent NW1	Not Needed To Many Public Houses	12/8/2017
A. BRAND	Rous Rd	Noise & Parking Issues	13/8/2017
Dana Miller	High Street Chesham	Not needed	15/8/2017
Mark Butler	MARTINE END WILKINSON ROAD CB8 8YH	RESIDENTIAL AREA	15/8/2017

This page is intentionally left blank